

Technical data sheet

Black powder-coated steel sleeve, with thread

Item number: 2046524



Accessory part: coupling with thread according to EN 60423 to connect electrical installation pipes and 90° bends.



- St** Steel
- PE50** PES50 - Polyester/epoxy

Master data

Item number	2046524
Description 1	Conduit threaded coupler
Description 2	with thread
Manufacturer	OBO
Dimension	M25x1,5
Colour	Jet black; RAL 9005
Material	Steel
Surface	PES50 - Polyester/epoxy
Surface standard	
Smallest sales unit	50
Unit of quantity	Piece
Weight	5 kg
Weight unit	kg/100 pc.
CO Footprint (GWP) Cradle-to-Gate	0,1892 kg COe / 1 Piece

Technical data sheet

Black powder-coated steel sleeve, with thread

Item number: 2046524



Dimensions

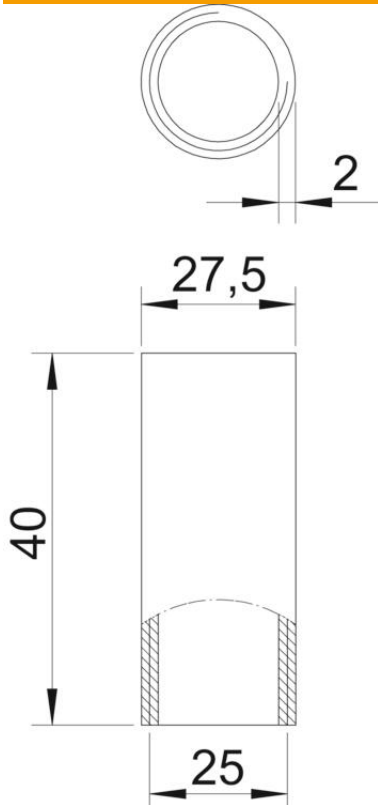

Length	40 mm
Dimension D	27.5 mm
Dimension d	25 mm
Dimension L	40 mm
Dimension m (mm)	M25
Dimension t	2 mm

Technical data

Version for pipe diameter	Thread
Thread	25 mm
Size	M25x1,5
Halogen-free	25
With inspection opening and lid	no
Brushed surface	no
Polished surface	no
Permitted temperature range, max.	250 °C
Permitted temperature range, min.	-45 °C
Two-part	no